

# Bleu tek Systems

## Niche installation

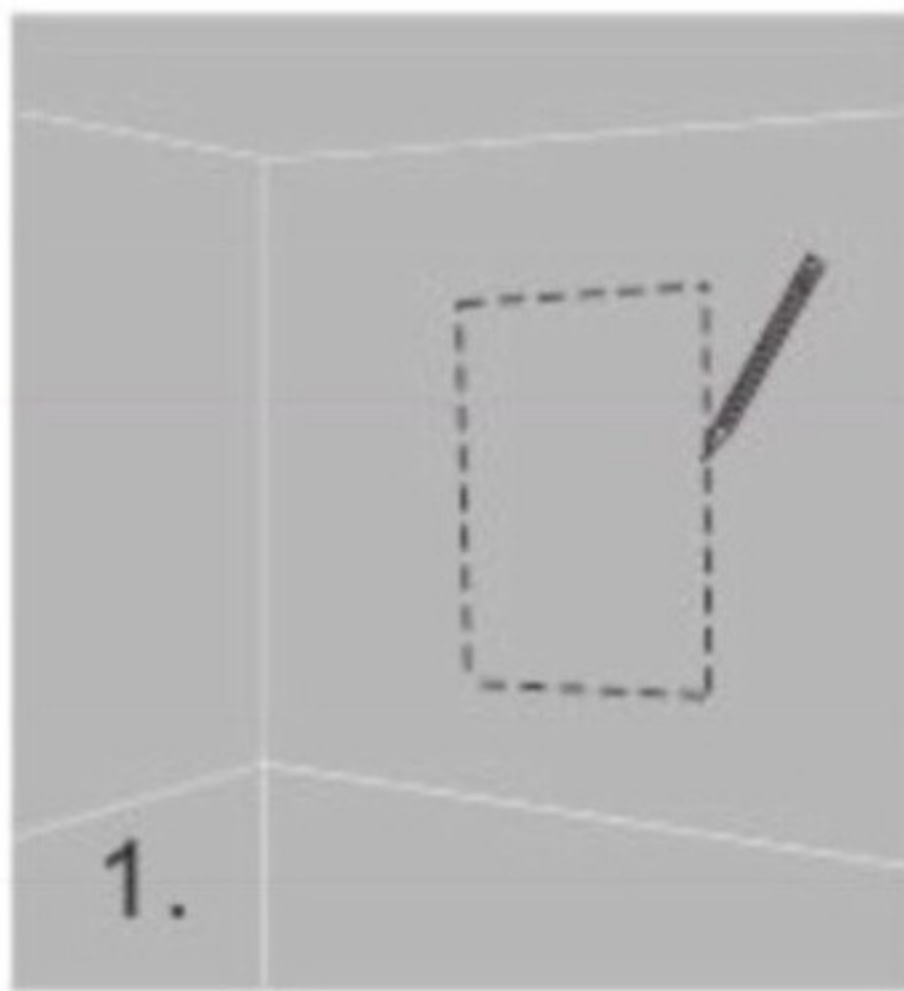

1. Determine desired height of niche and draw level line on substrate layer. Place BTS niche centered on level line

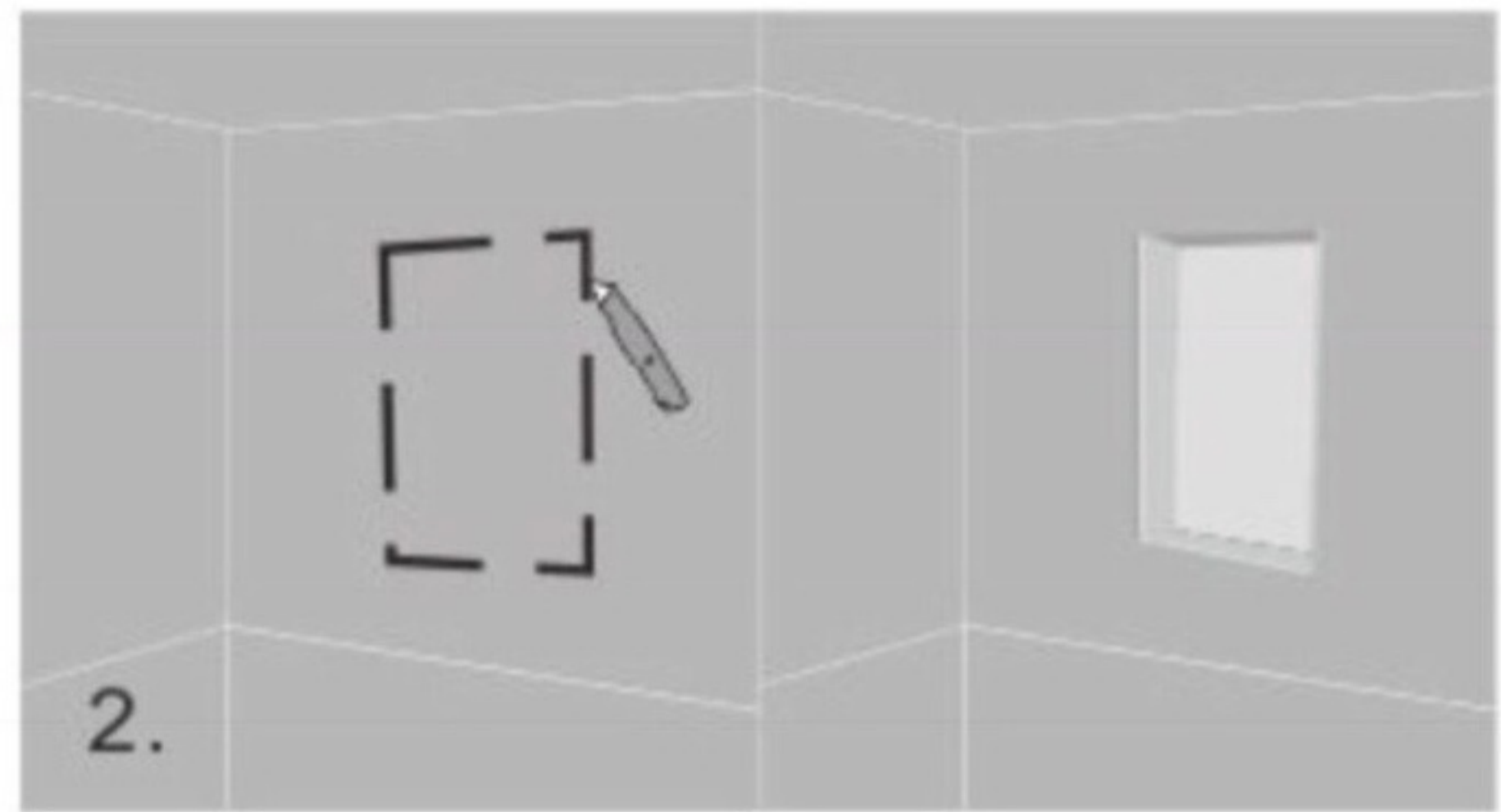

2. Cut along line and remove top substrate layer if necessary. Install horizontal cross bracing to support BTS niche.

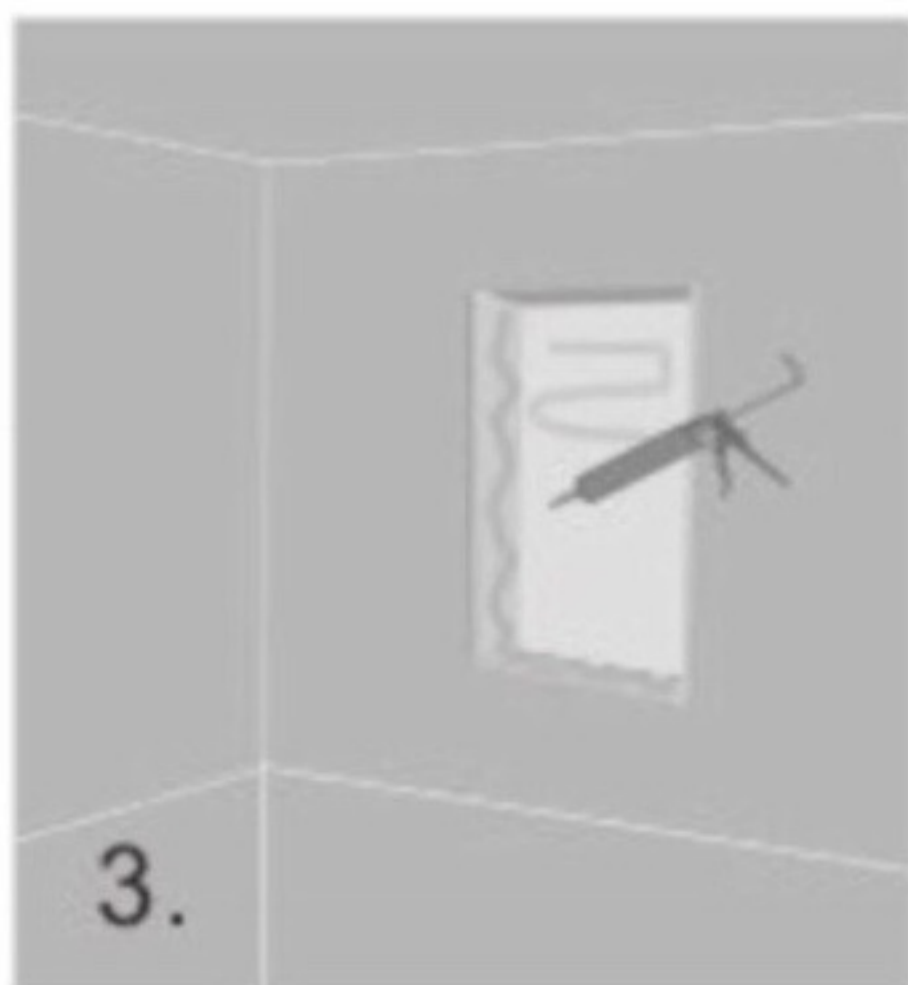

3. Use waterproof sealant to adhere BTS niche to studs.

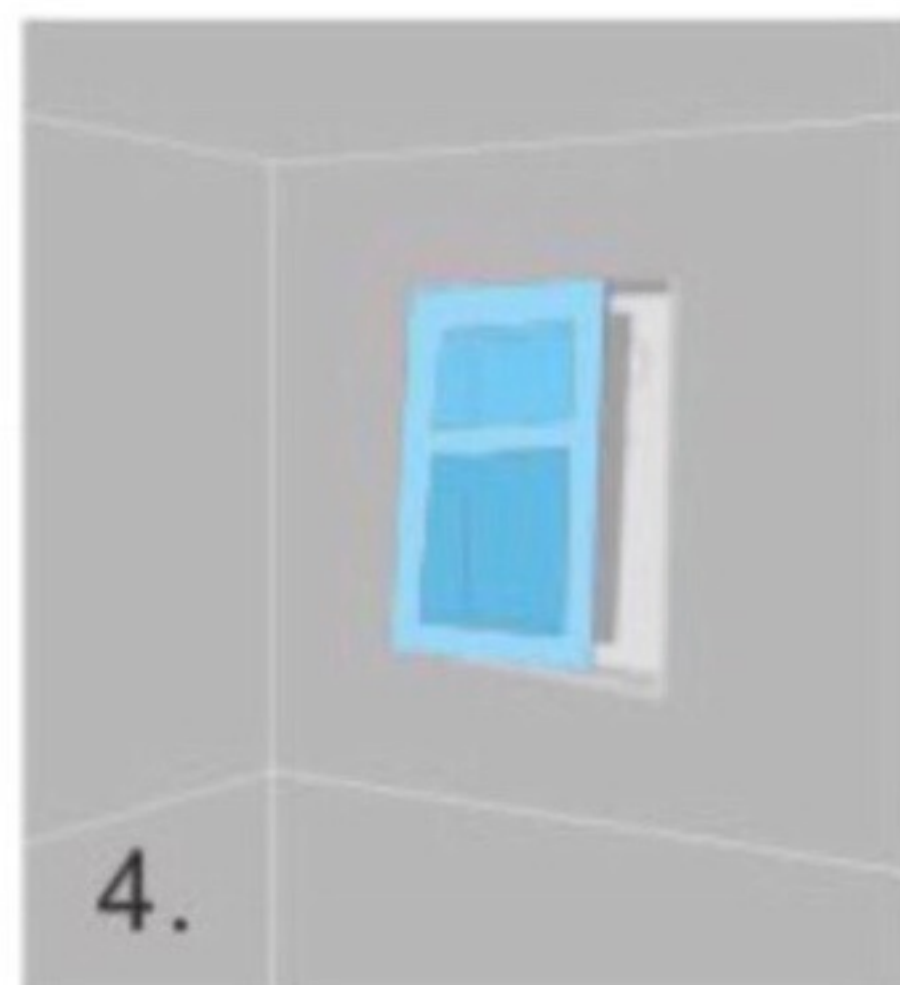

4. Seal joints between BTS niche and backer board with waterproof sealant.

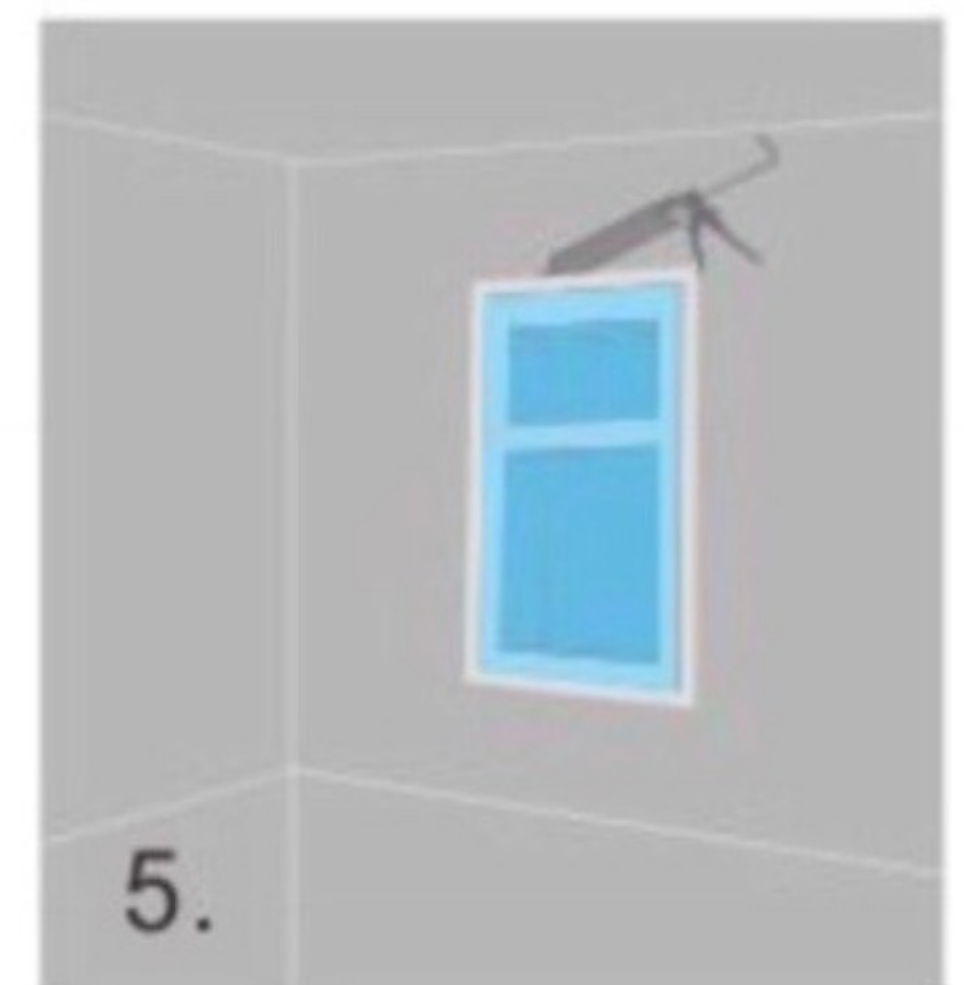

5. It is now waterproofed and ready to tile